

TYPE

# C14

2 BED  
2 BATH

<b>APARTMENT</b>	<b>52, 68, 84, 100, 116</b>
Apartment Area	87m <sup>2</sup>
Balcony Area	17m <sup>2</sup>
<b>Total Living Area</b>	<b>104m<sup>2</sup></b>
Car Bays	1 or 2*
Store	4m <sup>2</sup>

<b>APARTMENT</b>	<b>60, 76, 92, 108, 123</b>
Apartment Area	87m <sup>2</sup>
Balcony Area	16m <sup>2</sup>
<b>Total Living Area</b>	<b>103m<sup>2</sup></b>
Car Bays	1 or 2*
Store	4m <sup>2</sup>

<b>LEVEL</b>	<b>LEVEL</b>
<b>03, 05, 07, 09, 11</b>	<b>04, 06, 08, 10, 12</b>
Apt. No. 52, 68, 84, 100, 116	Apt. No. 60, 76, 92, 108, 123

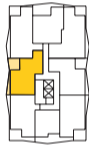
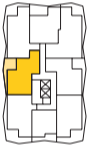

APARTMENT 60 SHOWN

\*Refer to strata plans



GENERAL NOTES: Variations from strata plans may apply. Furniture is indicative. Shape and configuration of living areas balconies, wall structure, doors, windows, aircon condensers and ducts may differ from those illustrated. Areas of apartment given are based on architectural measurements which varies from strata areas as different methods of measurement is applied.

0 1 2 3M

